

Key Features

- Successfully completed the PR2 Performance Verification Test of API 6A Appendix F and API 17D Section 307.
- The stem seal is a unique Moly filled PTFE multi-ring chevron style gland set incorporating two spring energised 'U' cup seals.
- Metal to Metal tip to body seal and backseat
- Low operating torques.
- Non-rotating tips, ensuring positive non-galling operation during shut-off and long service life.
- Standard certification for pressure retaining and controlling parts are to API 6A PSL 3 and BS EN 10204 3.1. (3.2. option available).

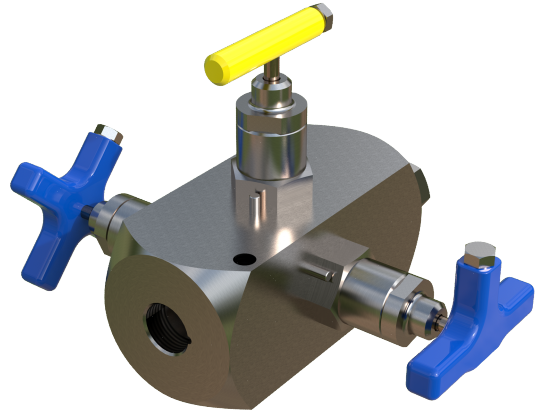

Technical Specification

- Bore size, 1/4" [6mm].
- Pressure rating, 10,000psi [690 bar].
- Performance tested to PR2 for Temperature Classification V (35°F/2°C to +250°F/121°C).
- Available in API Material Class FF to NACE MR-01-75 latest Rev.



Operator

- Normal Operating Torque 5ft-lbf [7Nm], 4 turns.
 - Torque to Damage 20ft-lbf [27 Nm].
 - Cross-bar or Tee-bar option for divers. Blue and Yellow colours available to assist identification.
- Not recommended for ROV operation**

Images shown are a Diver Operated Double Block & Bleed needle valve (Top) and a 10 valve multi-function manifold (bottom). Due to the many options and configurations available with this product please contact Oliver Valvetek Sales for a bespoke solution.

Rev 1.2

Oliver Valvetek Ltd, Parkgate Industrial Estate, Knutsford, Cheshire, WA16 8DX. United Kingdom.

T: +44 1565 632636 E: sales@valves.co.uk. W: www.valves.co.uk